

# VM15-RD

DUAL VOLUME CONTROL 4 WIRE OVERRIDE 2X15W



when communication is critical

## FEATURES

- Dual volume control, 4 wire override 2x 15W
- For use in SPA-V2 Public address and general alarm system
- For flush mounting
- Optional, wall mounting by using back box

## SPECIFICATIONS

Material / Colour	Black anodized aluminium
Dimension (mm)	144W x 144H x 82D
Mounting	Flush with 4x4 mm screws
Cable gland	4 x PG-16
Input	From 100V amplifier
Output	100V
Output power	2 x 15wW
Override power supply	24V DC
Termination	Plugable screw terminals for max 2.5mm <sup>2</sup> cable
Weight	0.7 kg

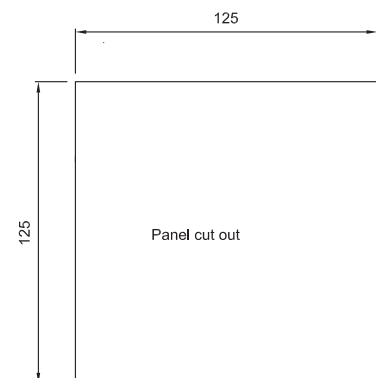
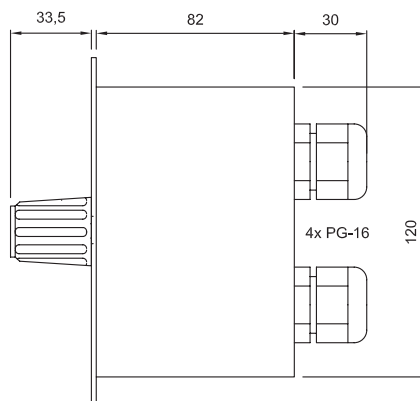
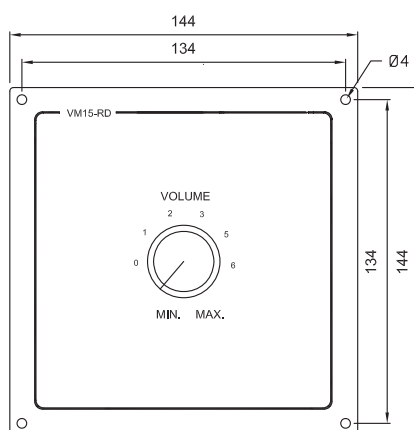
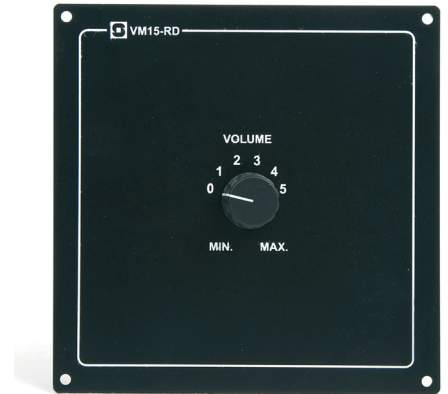

ORDER NUMBER	DESCRIPTION	SHIP WEIGHT
VM15-RD	Dual volume control, 4 wire override flush mounting 2x 15W	0.70 kg
Optional STBOKS5	Wall mounting box for volume controls VM15-RD and VM50-RD	0.22 kg

ORDER NUMBER  
**VM15-RD**

DOC NO  
**A100K10575**

[www.vingtor.com](http://www.vingtor.com) - [sales@vingtor.com](mailto:sales@vingtor.com)

