

3006102087

PD2100-230-LED

LED Continuous Light with General Alarm Symbol



Description

Machine lights in an elegant pyramid design, equipped with LED light source for extremely long service life (50000 hrs)

- ✓ Vibration/shock-resistant
- ✓ Low power consumption
- ✓ Minimised maintenance costs
- ✓ Non-compromising safety
- ✓ Outstanding illumination of the coloured lens due to scattering lens

Technical Dimensions

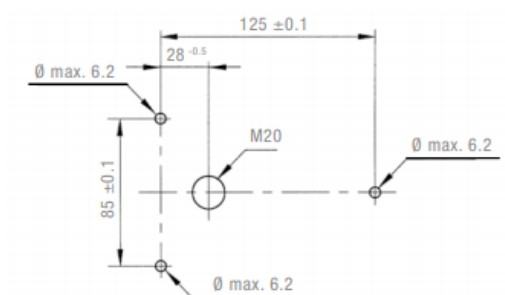

Specifications

GENERAL

Rated voltage	230 VAC
Operating range	207–253 V
Nominal current consumption	12 mA
Light source	LED
Light intensity (DIN 5037)	5 cd
Max. viewing distance	52 m
Operating temperature	–25 °C, +55 °C
Protection system (EN 60529)	IP55
Weight	380g