

## EN54 CEILING SPEAKER

- 50W 100V 2-WAY LOUDSPEAKER
- SIZE 6.5" (165 MM)
- QUICK MOUNT
- MAGNETIC FASTENING GRILLE
- WEATHERPROOF TO IP21C
- METAL FIREDOME HOUSING
- ROTARY SWITCH POWER SELECTION
- EXCELLENT SOUND QUALITY
- FULLY CERTIFIED TO EN54-24



### OVERVIEW

The SPCM-50W-65-EN54 is a 50W 100V 2-Way ceiling loudspeaker fitted with a Firedome for Voice Alarm applications. It has a 6.5" (165mm) loudspeaker chassis with a high quality tweeter providing excellent sound quality for speech and background music.

Certified to EN54-24 the speaker is fitted with a 100V transformer with four power level adjustment tapings of 50W, 25W, 12.5W and 6.25W, selectable using a rotary switch on the front of the speaker, behind the grille. Low impedance operation is also possible.

The sturdy metal Firedome housing in RAL 9016 guarantees long-term durability. For additional reliability, a thermal fuse is provided. The speaker is protected to class IP 21C and the speaker chassis is treated against damp.

Easy installation is made possible through a simple screw mounting system. Using a magnetic fastening, the finely perforated speaker grille can be removed quickly for access to the power rating switch and the grille can be easily replaced by a different coloured grille, even after installation.

The loudspeaker is optionally available with a DC blocking capacitor fitted, in order to provide compatibility with DC loudspeaker line monitoring systems. The part number for this DC monitoring compatible version is SPCM-50W-65-EN54-DC.

EASE data is available for this speaker on request.

**PRODUCT ATTRIBUTES**

Description	SPCM-50W-65-EN54
Power Tappings	50 / 25 / 12.5 / 6.25 (8) W
Impedance	200 / 400 / 800 / 1600 ohm
Frequency Range	65 - 24,000 Hz
Frequency Response	80 - 22,200 Hz
SPL 1W / 1m, peak	94.1 dB
SPL 1W / 4m, peak	82.1 dB
SPL Pmax / 4m, peak	99.0 dB
Sensitivity EN54-24, 1W / 4m	77.5 dB
Sensitivity IEC 268-5, 1W/1m	89.5 dB
Dispersion (-6dB, 500Hz) & Dispersion (-6dB, 1KHz)	180°
Dispersion (-6dB, 2KHz)	140°
Dispersion (-6dB, 4KHz)	56°
Temperature Range	-10 / +55 °C
Dimensions	264 x 240mm
Ceiling Cut-out	238mm
Weight (net)	3.75 kg
Colour	RAL 9016 (Traffic White)
Connector	4-way clamp terminal
Mounting	Screws
IP Rating	IP21
Maximum cable cross section	4.9mm <sup>2</sup>
Maximum cable cross section loop	2 x 4.9mm <sup>2</sup>
Packing Unit	8

POLAR DIAGRAM

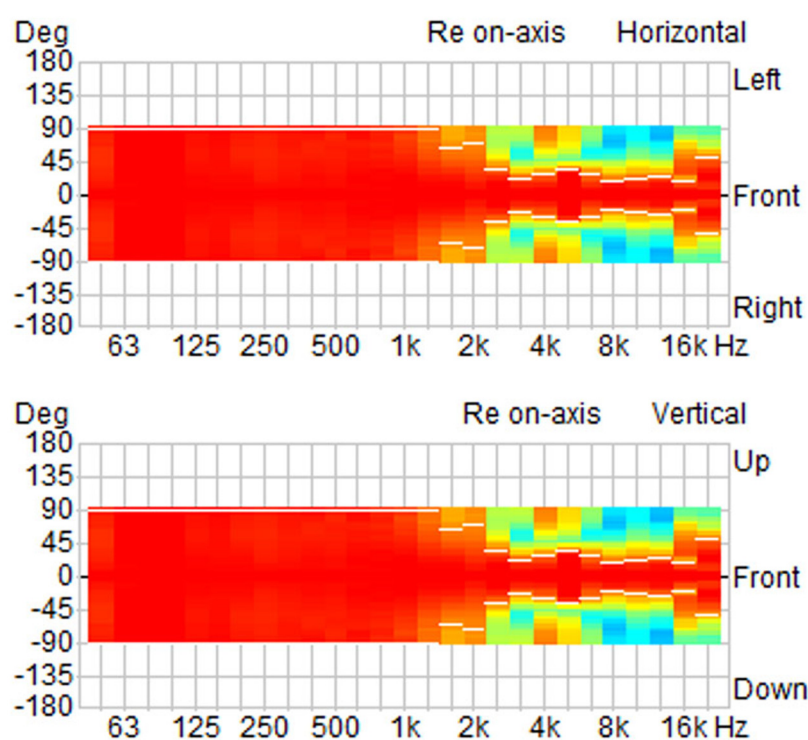

FREQUENCY RESPONSE DIAGRAM

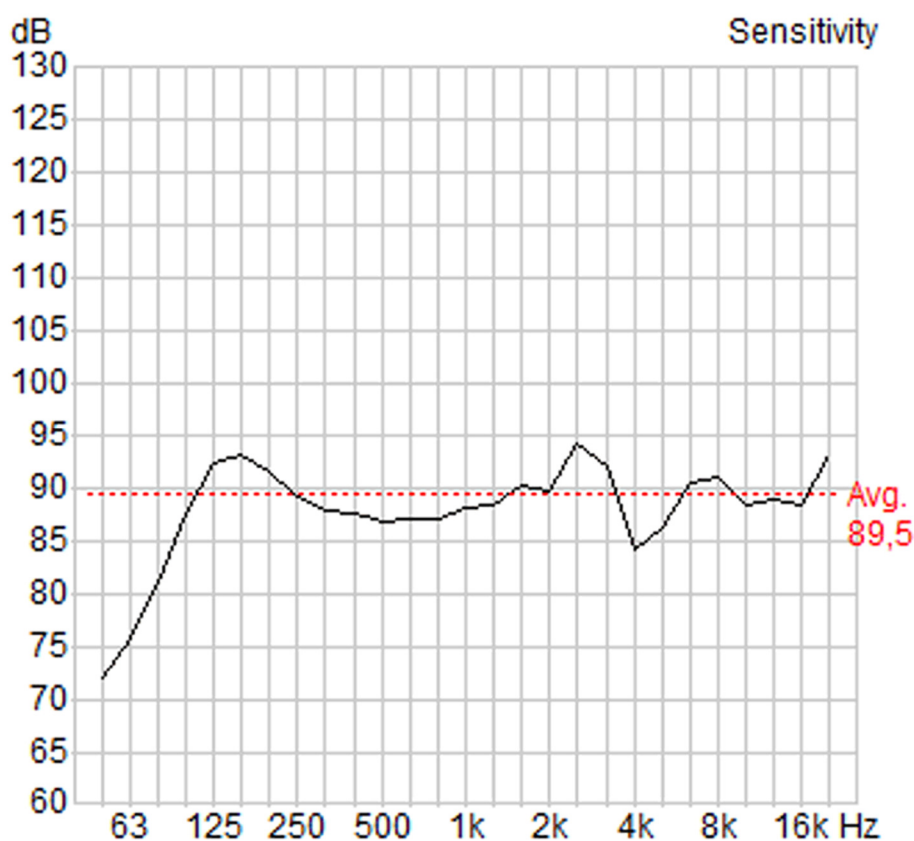

**DIMENSIONAL DIAGRAM**

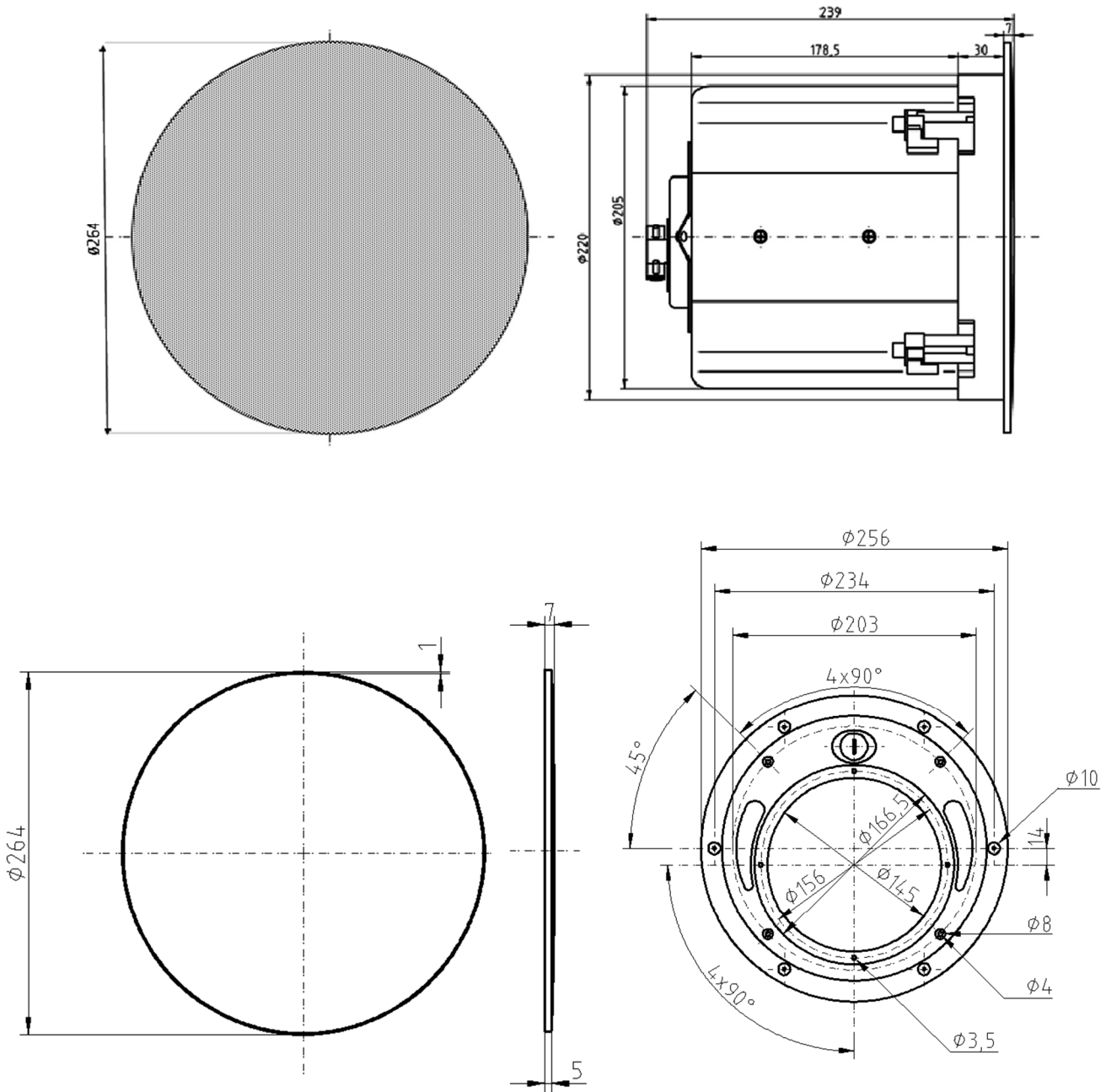

Measurements according to DIN IEC 268-5  
 RoHS compliant (2011/65/EU & 2015/863/EU)



This equipment is designed and manufactured to conform to the following EU Directives:

Low Voltage: 2014/35/EU  
 Restriction of Hazardous Substances (RoHS): 2011/65/EU & 2015/863/EU

**Manufacturer**

Application Solutions (Safety and Security) Limited  
 Unit 17 - Cliffe Industrial Estate - Lewes - East Sussex - BN8 6JL - U.K.  
 Tel: +44(0)1273 405411

[www.asl-control.co.uk](http://www.asl-control.co.uk)

All rights reserved.

Information contained in this document is believed to be accurate, however no representation or warranty is given and Application Solutions (Safety and Security) Limited assumes no liability with respect to the accuracy of such information.



Assessed to ISO 9001  
 LPCB Cert No: C1043