



Provide a Voice to Your Video Management Workflow

Zenitel integrates with
Hanwha Vision's Wisenet WAVE VMS

WISeNET WAVE

Seamless Integration of Zenitel's Voice Communications with Wisenet WAVE.



Enhancing communication with crystal-clear audio in any environment adds a vital layer of safety and security that silent systems cannot provide.

By combining Zenitel's advanced audio technology with Hanwha Vision's Wisenet WAVE VMS, you elevate both security and operational efficiency.





This integration minimizes security gaps, improves decision-making, and speeds up response times.



Hanwha Vision's Wisenet WAVE VMS is an ideal choice for an integrated security solution that maximizes operational efficiency. It provides centralized management, monitoring, scalability and flexible system integration capabilities to meet the requirements for mid-large scale sites.

Zenitel integrates with Wisenet Wave through ONVIF, empowering organizations to enhance their situational awareness, threat response and traceability, by incorporating intercom device features such as **video streaming, audio streaming, audio talkback.**

Benefits of Integrating Zenitel's Audio and Voice Communication devices into your Video Management Workflow:

- 
QUICK AND EASY SETUP
 Zenitel's audio and video devices can be seamlessly added to Wisenet WAVE as ONVIF devices. The auto-discovery feature of devices saves both time and money.
- 
IMMEDIATE RESPONSE
 Broadcast live messages to IP speakers to respond swiftly to security events.
- 
COMPLETE SITUATIONAL AWARENESS
 Utilize ambient listening to gain audio context for what is seen on camera, mitigating security risks and enabling better decision-making and faster response times.
- 
IMPROVED ACCOUNTABILITY
 Record, replay, and log audio and video streams for traceability and accountability, ensuring comprehensive documentation of all interactions.
- 
AUDIO AND VIDEO ACCESS CONTROL
 Manage visitors and verify identities through both visual and audio communication, enhancing security measures.
- 
SUPERVISE AND MONITOR
 See and verify the status of each intercom device to ensure all units are operational and secure.

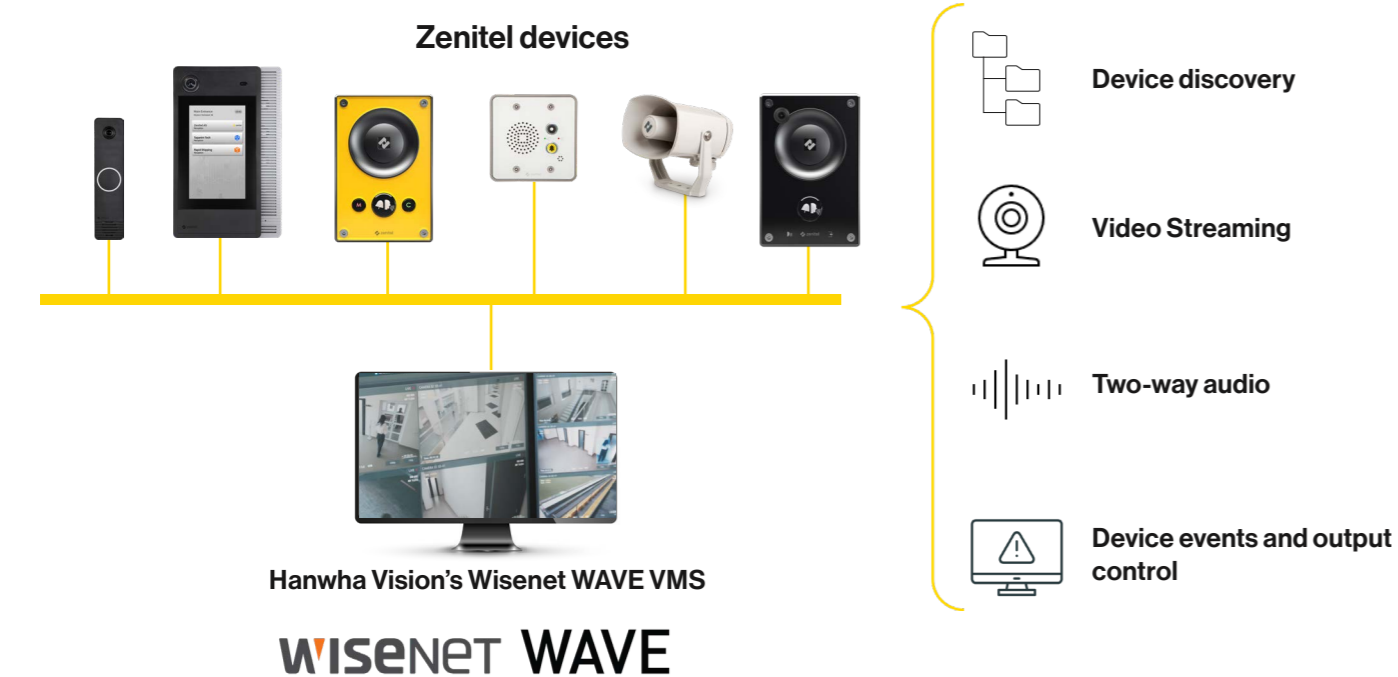

System Integration Features

Hanwha Vision's Wisenet WAVE VMS.

Zenitel audio and video devices can be added to Wisenet Wave as ONVIF devices.

Device discovery and configuration	
Auto-discovery of Zenitel devices	✓
Zenitel devices can be added to customized views	✓
Customizable device rules and events	✓
Video resolution, codec and stream settings	✓
Video and Audio features	
Video live stream	✓
Bi-directional audio live stream	✓
Video and audio recording (manual and event-based)	✓
Video and audio playback	✓
Other	
Log files for device events (i.e. call button push, input triggered, output triggered)	✓
Intercom events create notifications in Wisenet Wave	✓



Whether it's perimeter management, access control, indoor or outdoor security, Zenitel solutions bring you more flexibility and control to enhance and manage your facility's security and safety. Thanks to ONVIF compatible software it's easier to integrate and map Zenitel solutions with other security systems, while giving your security team more tools to manage not just video but also audio under the same control interface.



Why Zenitel?

Zenitel is well positioned to drive the future of intelligent critical communication solutions. Through our portfolio of IP products and solutions, with built-in intelligence and a focus on cybersecurity, we provide organisations with superior, scalable security and flexibility. Zenitel is the proven, preferred choice for environments requiring crystal-clear audio to ensure the protection of human life, property, assets and the management of critical activities. With interoperability at all levels, we seamlessly integrate with access control, video management and security platforms.